

8 7 6 5 4 3 2 1  
 THIS DOCUMENT IS THE PROPERTY OF DME INC., AND CANNOT BE DISTRIBUTED WITHOUT DME'S AUTHORIZATION

REVISIONS				
ZONE	REV.	DESCRIPTION	DATE	APPROVED

### BILL OF MATERIAL

ITEM	QTY	DESCRIPTION	MATERIAL
1	1	INTERFACING CYLINDER,	C/S
2	1	OUTER CYLINDER,	C/S
3	1	LID,	C/S
4	4	SUPPORT TABS,	C/S
5	4	HEX BOLTS,	C/S
6	4	HEX NUTS,	C/S
7	4	TABS,	C/S

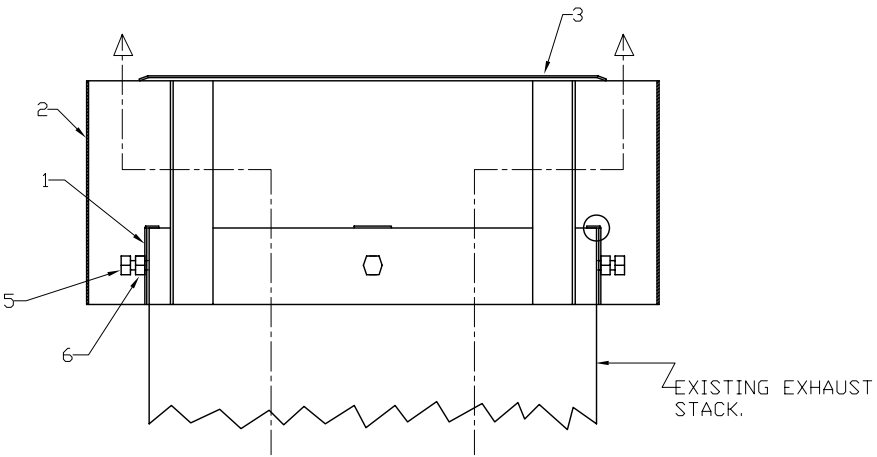
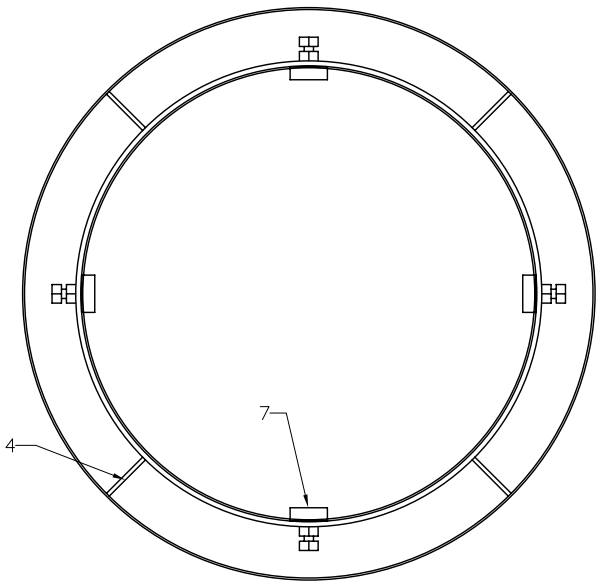

GENERAL NOTES:

A. ALL WELDING SHALL BE IN ACCORDANCE WITH ASME SECTION IX.

APPROVED BY:.....

DATE:..... PO#:.....

ALL DIMENSIONS ARE IN INCHES



**DME INC.**  
 14001 MARQUARDT AVE.  
 SANTA FE SPRINGS, CA 90670  
 TEL: 562-921-0464  
 FAX: 562-802-7489

\*\*\*\*\*  
 ANY CHANGES ON THE DRAWING MUST BE REPORTED AND APPROVED ONLY BY THE ENGINEERING DEPARTMENT  
 \*\*\*\*\*

CUST: JOB#		SIZE	DWG NO.	REV.
DESIGN: PER CUST.	03-26-2013	-	RDP-SUB	
APPROVED BY: E.F.	03-26-2013	SCALE	DATE:	SHT
DWG: L.T.	03-26-2013	NONE	03-26-2013	1 OF 1

<b>RAIN DEFLECTOR</b>	
UNLESS OTHERWISE SPECIFIED TOLERANCES ARE :	
.XXX ± .010"	FRACTIONS: ± 1/8"
.XX ± .030"	EXP. JOINTS: OAL: ± 1/8"
.X ± .060"	ANGLES ± 1/2°